

Revell

KIT 5862

85586200200

BELL® X-1™

The Bell® X-1™ (experimental supersonic) was built specifically to probe the regime of supersonic flight. Measuring only 31 feet in length, the X-1 was a single-seat design powered by a four-chambered rocket motor that was fueled by a volatile mixture of alcohol and liquid oxygen. It was designed to be carried aloft in the belly of a B-29 Superfortress and launched in free fall for its assault on the sound barrier. On October 14th 1947 history was achieved when at an altitude of 42,000 in level flight the X-1 accelerated to Mach 1.07 and shattered the peaceful day with the rumble of the world's first sonic boom created by a manned aircraft. Your Revell model features a fully detailed cockpit with optional seated pilot figure, rocket engine and optional open or closed cockpit door and decals with authentic markings for four versions.

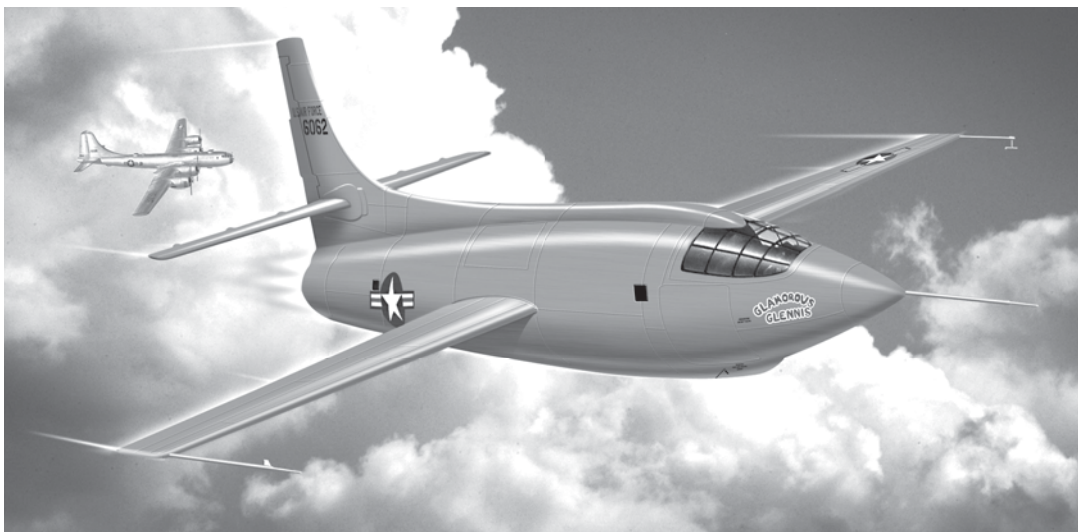

* REPEAT SEVERAL TIMES
* A REPETER PLUSIEURS FOIS



* REPEAT PROCEDURE
* RÊPÊTEZ LE PROCÉDÉ



* OPTIONAL PARTS
* PIÈCES EN OPTION



* DECAL
* DECAL COMANIE



* ASSEMBLY CAUTION
* ATTENTION D'ASSEMBLEE



* CEMENT TOGETHER
* A COLLER



* REMOVE AND THROW AWAY
* A RETIRER ET JETER



* DO NOT CEMENT
* NE PAS COLLER

READ THIS BEFORE YOU BEGIN

- * Study the assembly drawings.
- * Each plastic part is identified by a number.
- * In the assembly drawings, some parts will be marked by a star (★) to indicate chrome plated plastic.
- * For better paint and decal adhesion, wash the plastic parts in a mild detergent solution. Rinse and let air dry.
- * Check the fit of each piece before cementing in place.
- * Use only cement for polystyrene plastic.
- * Scrape plating and paint from areas to be cemented.
- * Allow paint to dry thoroughly before handling parts.
- * Any unused parts may be discarded.

DECAL APPLICATION INSTRUCTIONS

1. Cut desired decal from sheet.
2. Dip decal in water for a few seconds.
3. Place wet decal on paper towel.
4. Wait until decal is movable on paper backing.
5. Place decal in position on model, face up and slide backing away.
6. Press out air bubbles with a soft damp cloth.
7. Milkiness that may appear is for better decal adhesion and will dry clear. Wipe away any excess adhesive.
8. Do not touch decal until fully dry.
9. Allow the decals 48 hours to dry before applying clear coat.

NOTE: Decals are compatible with setting solutions or solvents.

LIRE CE QUI SUIT AVANT DE COMMENCER

- * Etudier les schémas de montage.
- * Chaque pièce en plastique est identifiée par un numéro.
- * Sur les schémas de montage, certaines pièces sont marquées d'une étoile (★) pour indiquer qu'elles sont en plastique chromé.
- * Pour une meilleure prise de la peinture et des autocollants, laver les pièces en plastique avec une solution détergente peu concentrée. Les rincer et les laisser sécher à l'air.
- * Vérifier que chaque pièce s'ajuste bien avant de la coller en place.
- * N'utiliser que de la colle pour polystyrène.
- * Gratter les parties à coller pour enlever le chrome et la peinture.
- * Laisser la peinture bien sécher avant de manipuler les pièces.
- * Toute pièce inutilisée peut être jetée.

DIRECTIVES D'APPLICATION DES AUTOCOLLANTS

1. Découper l'autocollant désiré de la feuille.
2. Tremper l'autocollant dans de l'eau pendant quelques secondes.
3. Placer l'autocollant mouillé sur une serviette en papier.
4. Attendez que l'autocollant puisse être déplacé sur son support en papier.
5. Mettre l'autocollant en position sur le modèle face sur le dessus et faire glisser le support pour l'enlever.
6. Appuyer avec un chiffon doux humide pour éliminer les bulles d'air.
7. La substance laiteuse qui peut apparaître est destinée à améliorer l'adhésion de l'autocollant et devient incolore au séchage. Essuyer pour enlever tout excédent d'adhésif.
8. Ne pas toucher l'autocollant tant qu'il n'est pas bien sec.
9. Laisser l'autocollant sécher pendant 48 heures avant d'appliquer une couche transparente.

REMARQUE: Les autocollants sont compatibles avec les solutions de fixation ou les solvants.

This paint guide is provided to complete this kit as shown on the box.

Ce guide de peintures est fourni pour reproduire le modèle réduit qui apparaît sur la boîte.

Brown	<i>Brun</i>
Semi Gloss Black	<i>Noir satiné</i>
Flat Black	<i>Noir mat</i>
Flat Red	<i>Rouge mat</i>
Flat White	<i>Blanc mat</i>
Gunmetal	<i>Bronze</i>
Medium Gray	<i>Gris moyen</i>
Orange FS 12197	<i>Orange</i>
Silver	<i>Argent</i>
Steel	<i>Acier</i>
Tan	<i>Tan</i>
Zinc Chromate	<i>Chromaate de zinc</i>

If you have any questions or comments, call our hotline at: **(800) 833-3570**
or, please write to:

Revell Inc Consumer Service Department, 1850 Howard Street Unit A, Elk Grove Village, Illinois 60007

Be sure to include the plan number (85586200200), part number, description, your return address and phone number.

Visit our website: www.revell.com

1

ROCKET ASSEMBLY

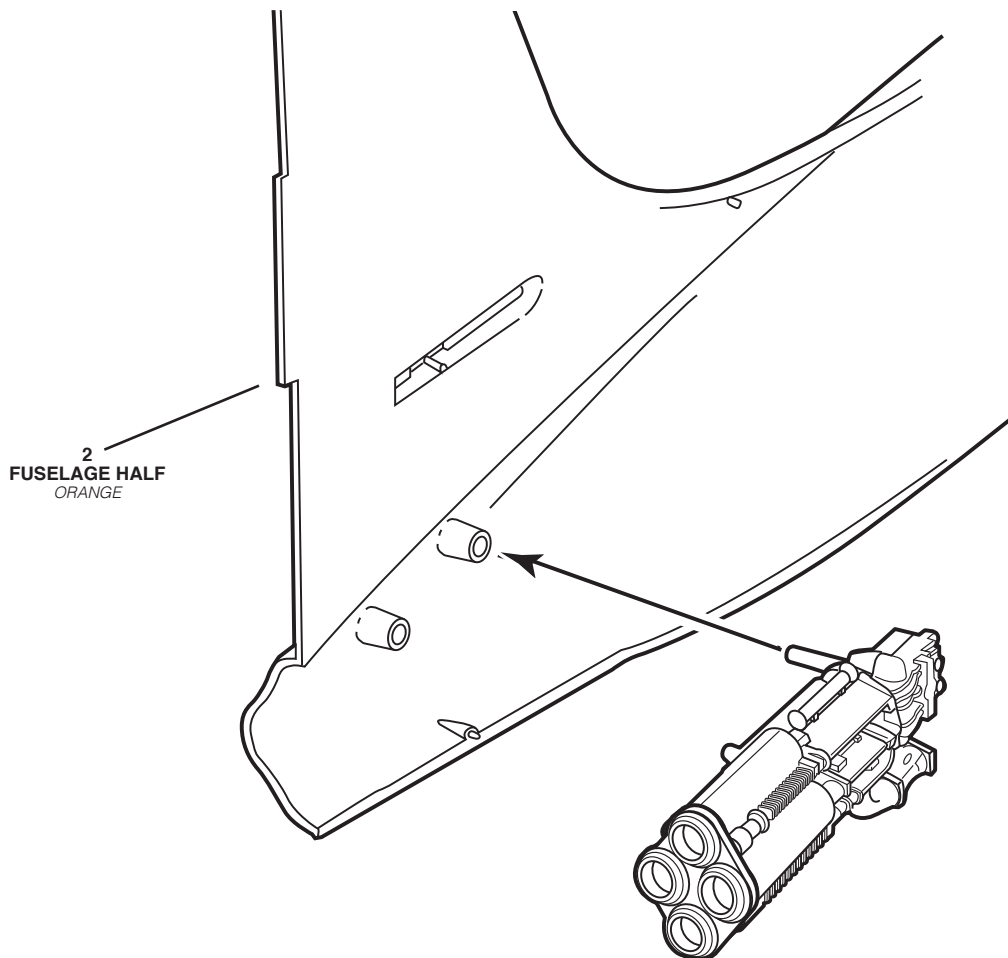
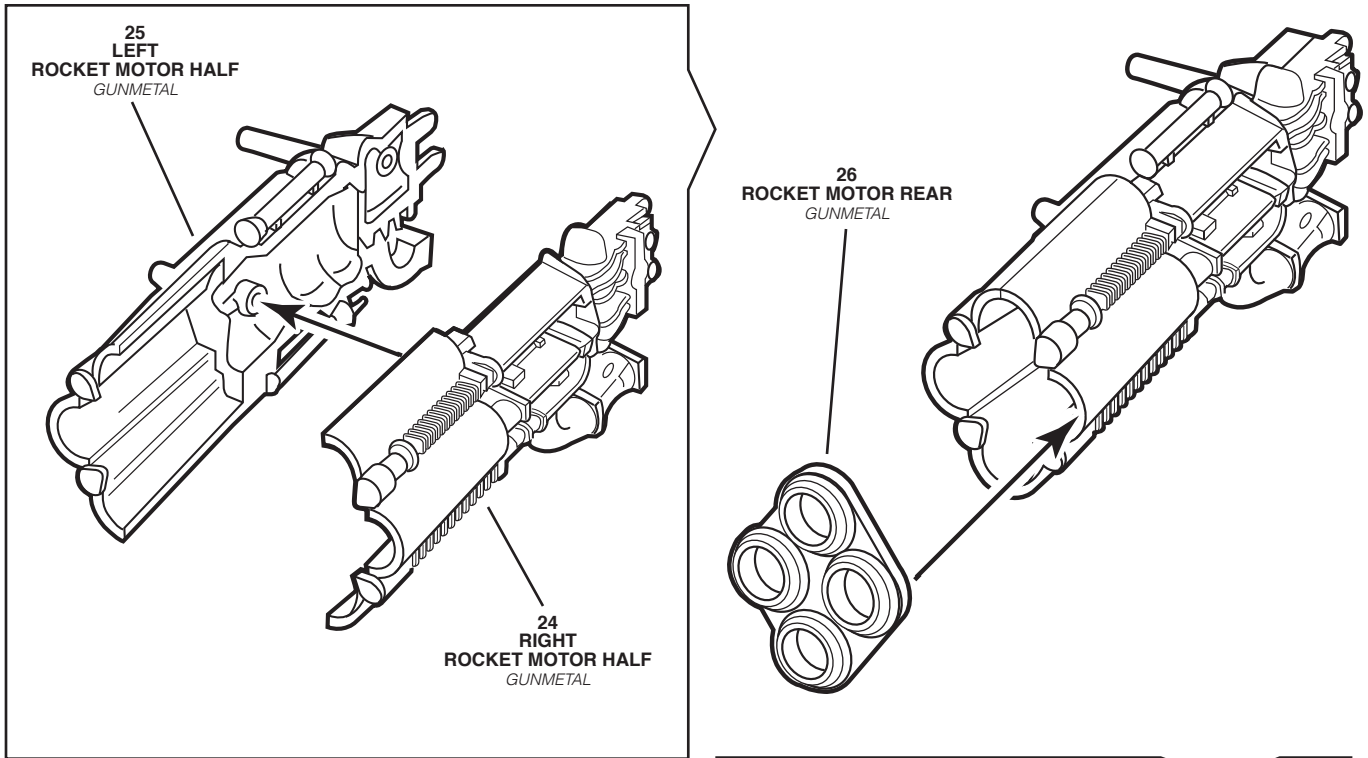

2

COCKPIT ASSEMBLY

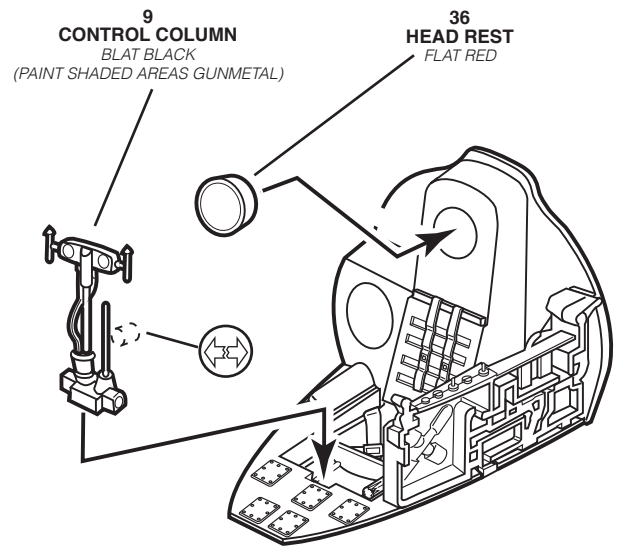
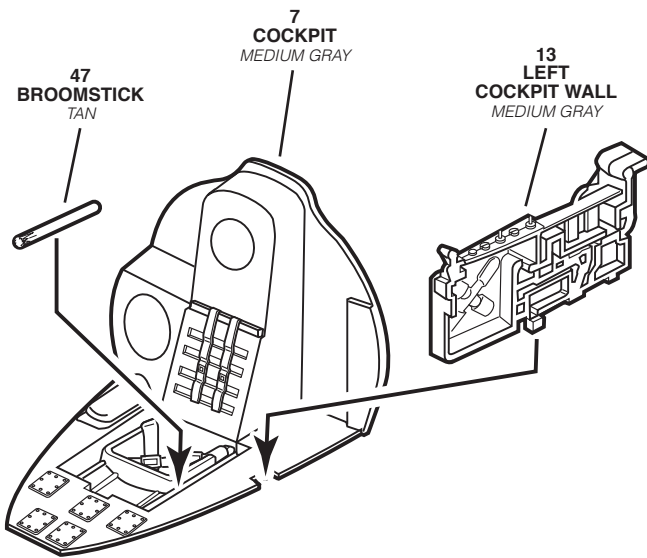

3

NOSE WHEEL ASSEMBLY

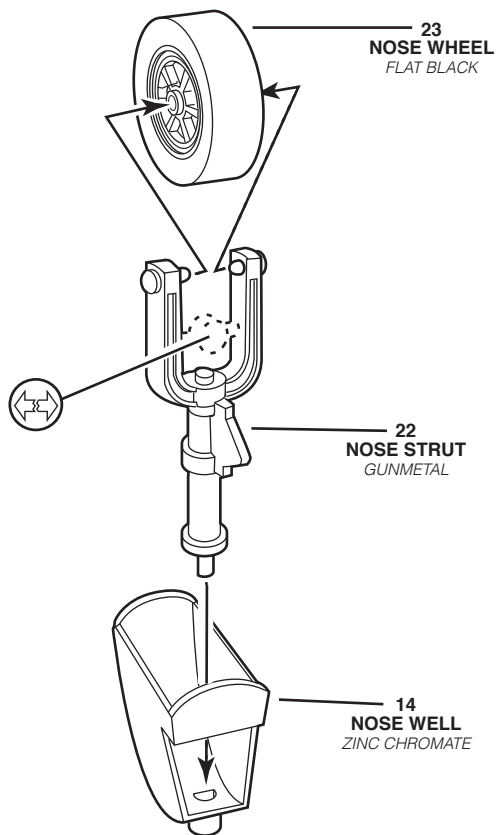

COMPLETED COCKPIT ASSEMBLY

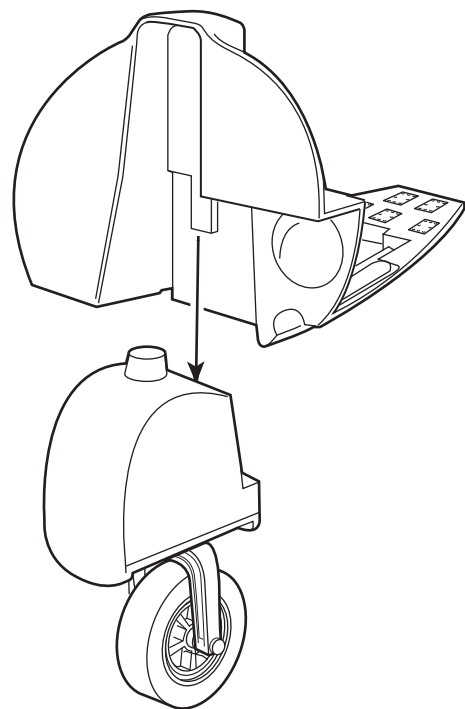

4

PILOT ASSEMBLY

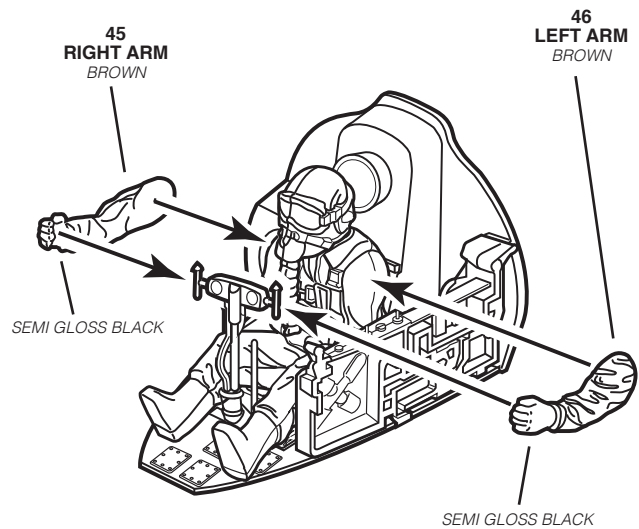
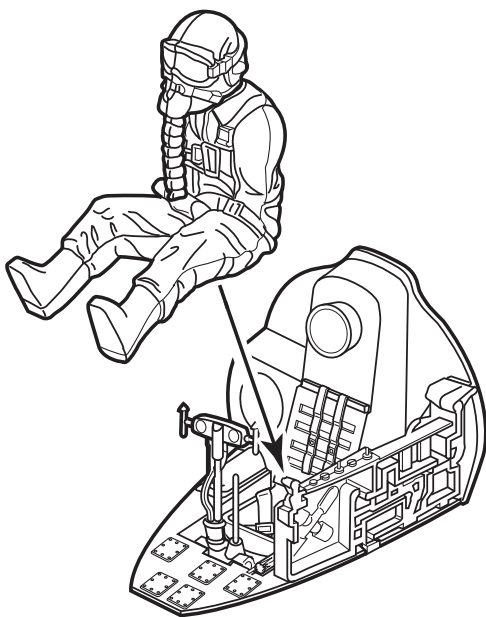
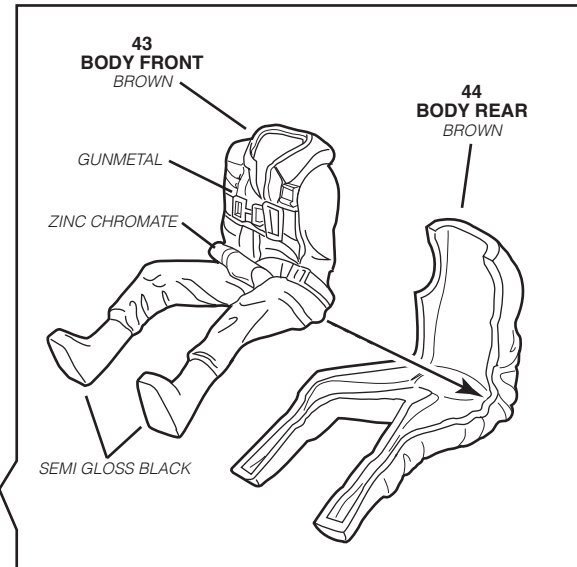
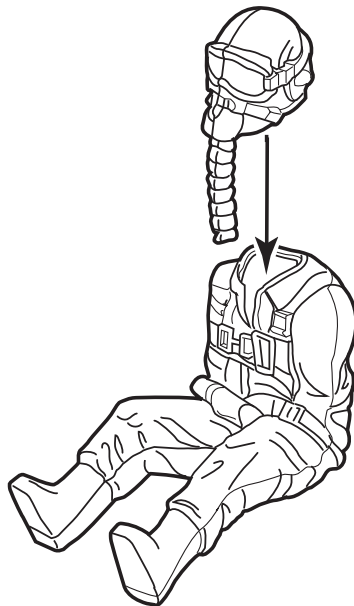
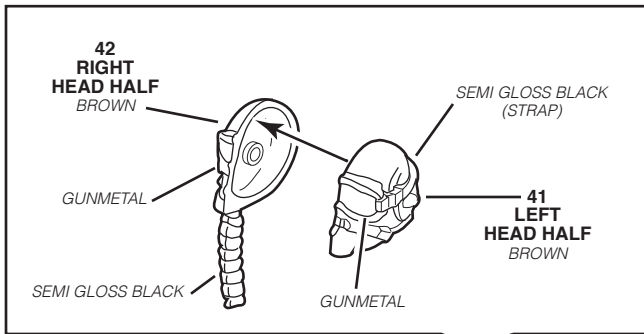

5

FUSELAGE ASSEMBLY

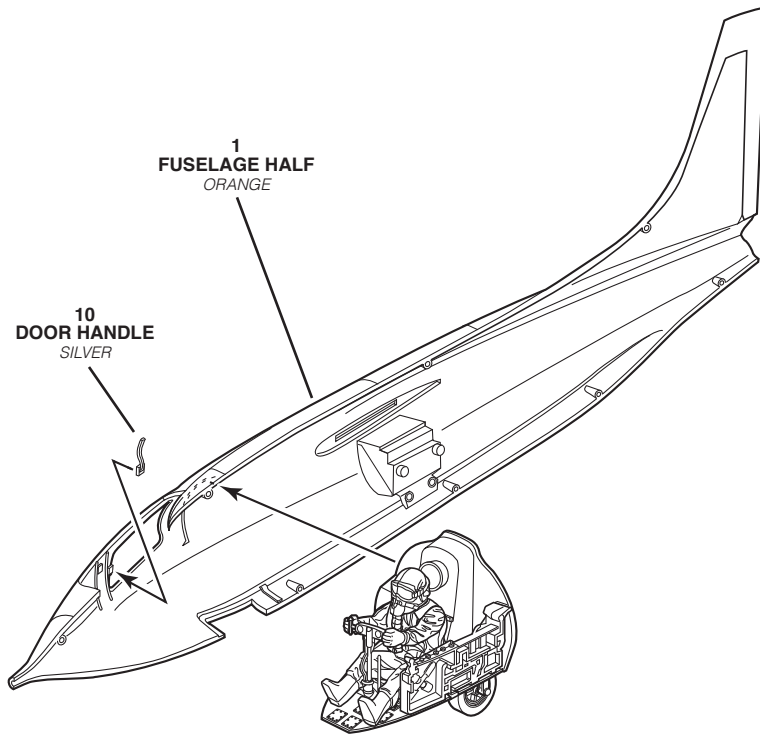

NOTE: OPEN HOLE ON # 2 FUSELAGE HALF IF USING SUPPORT (51) SEE STEP 11

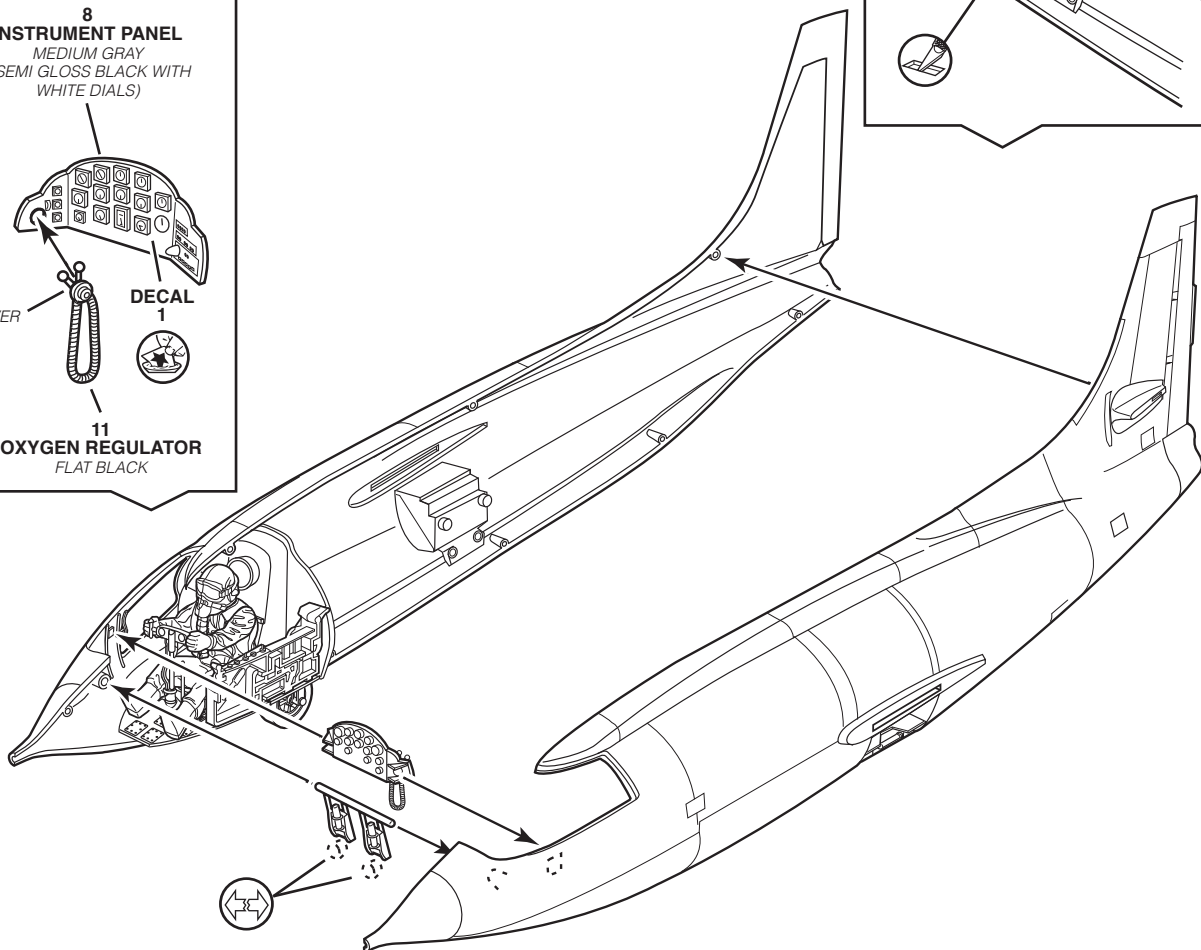
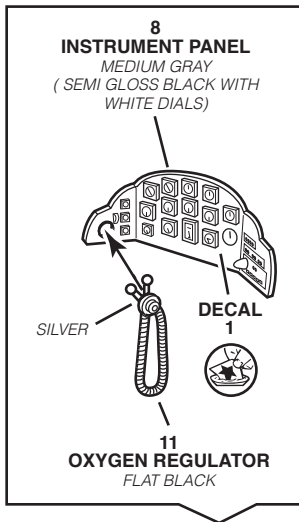
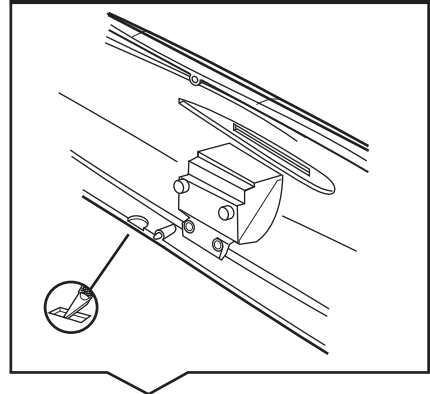

6

STRUT ASSEMBLY

LEFT

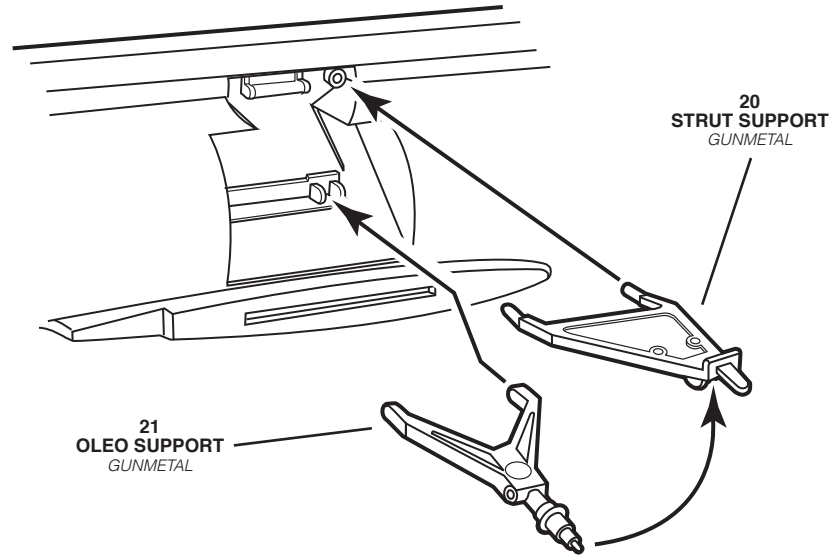

RIGHT

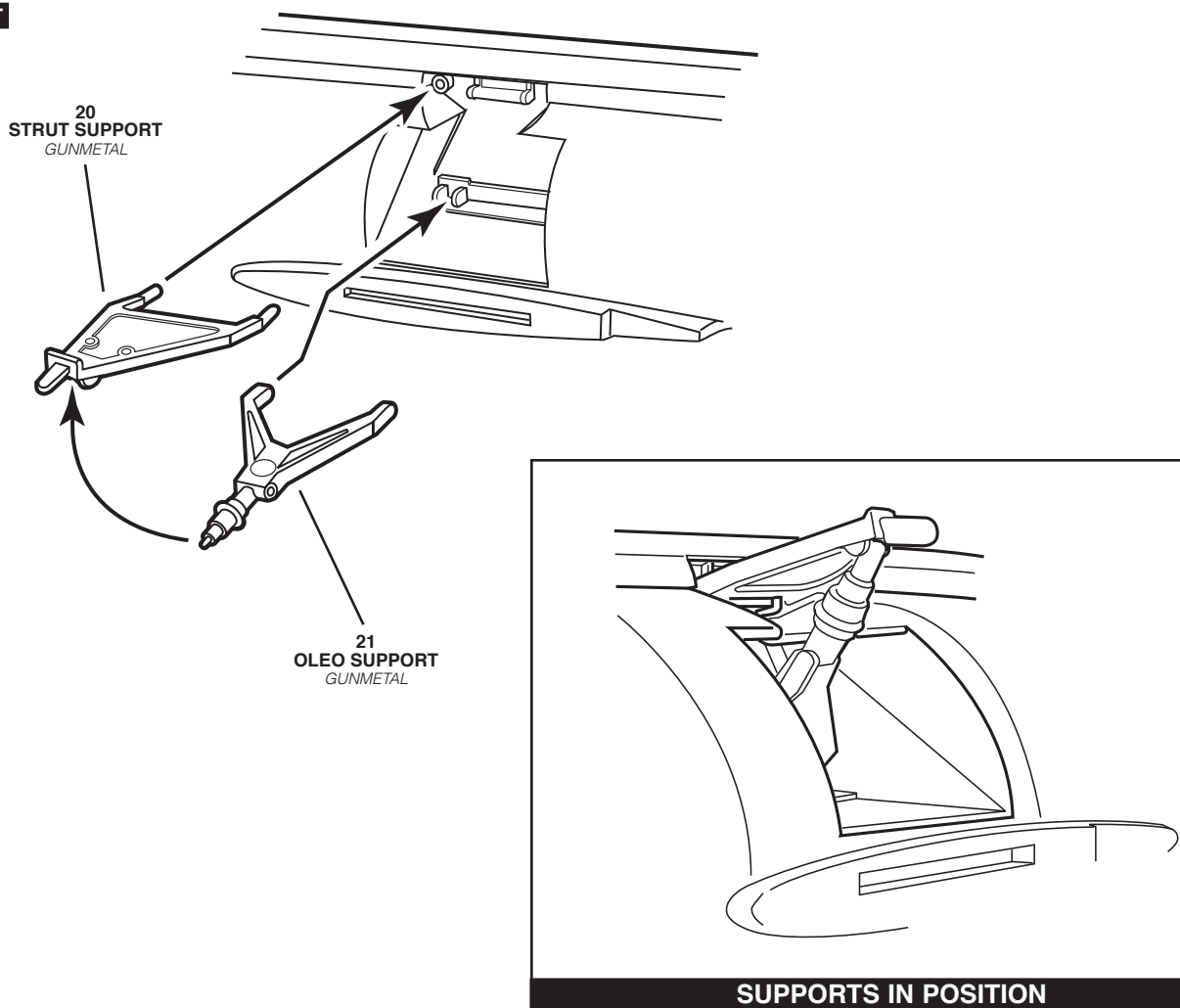

7

WHEEL ASSEMBLY

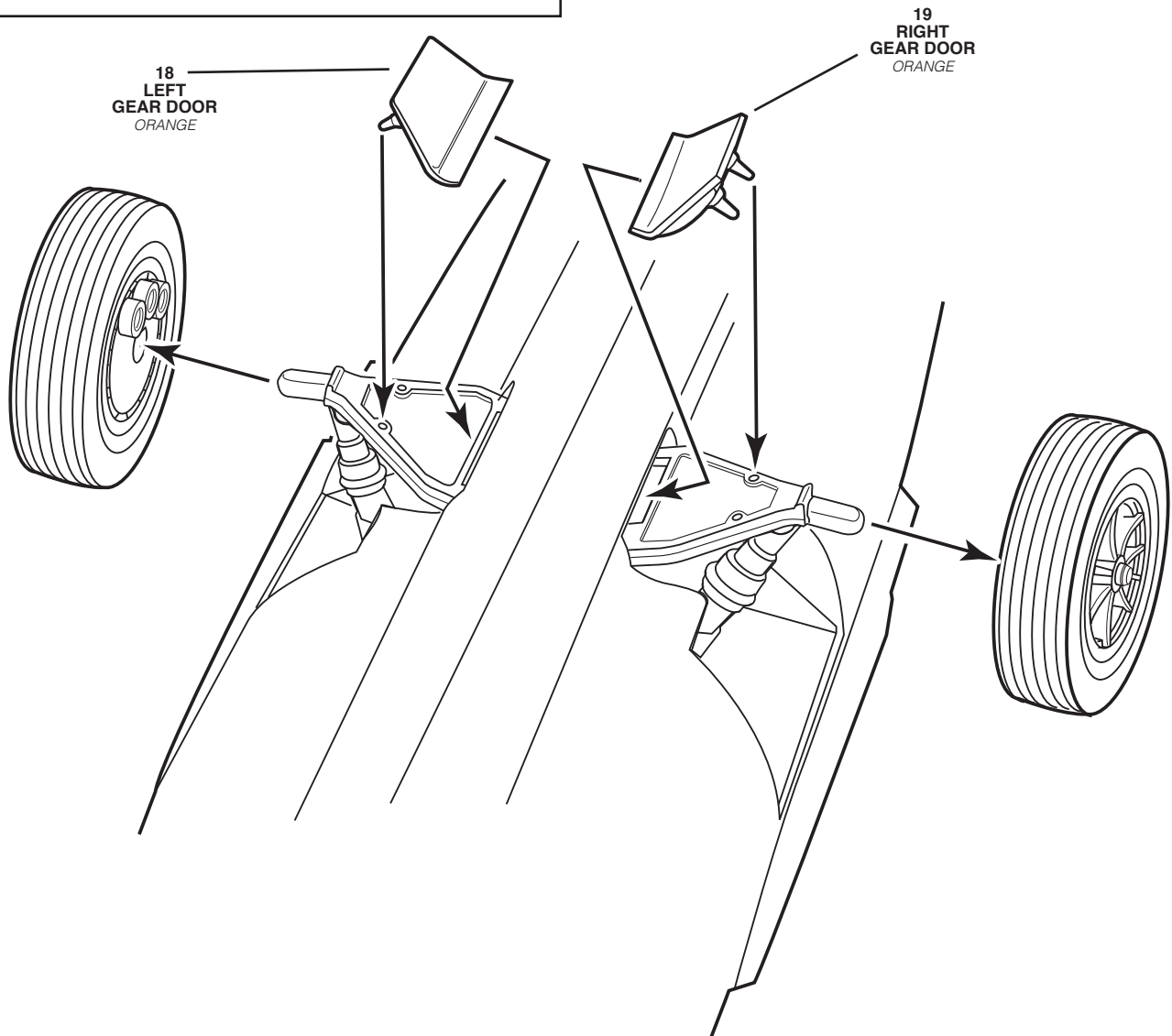
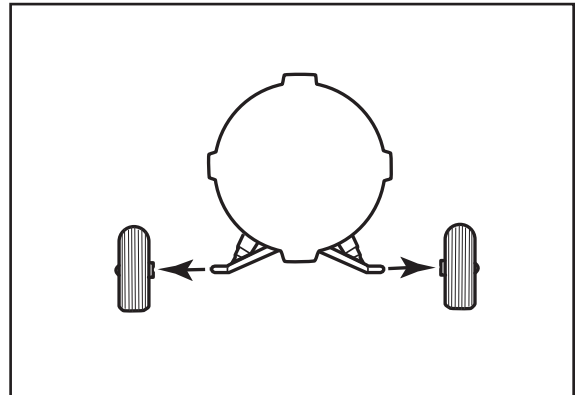
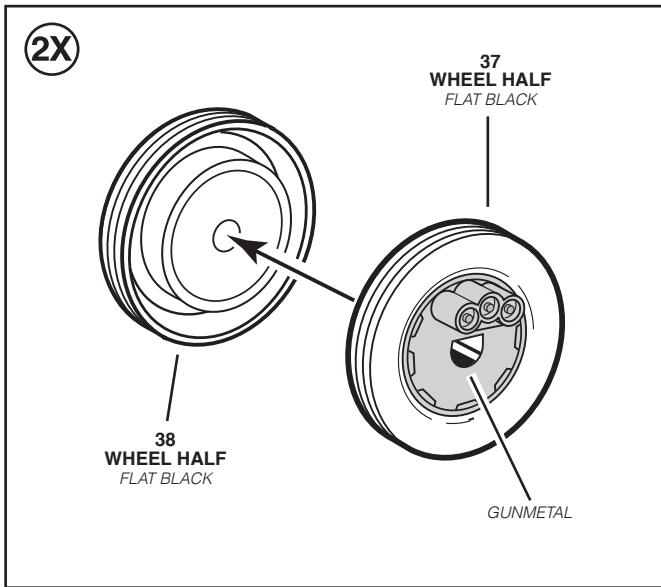

8

MAIN / NOSE DOOR ASSEMBLY

MAIN DOOR

2X

17
MAIN DOOR
ORANGE
(ZINC CHROMATE INSIDE ONLY)

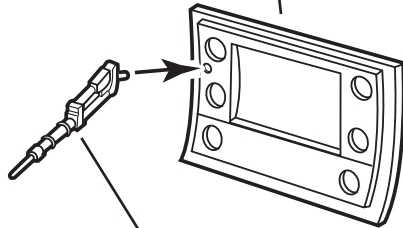

32
RETRACTING STRUT
GUNMETAL

RIGHT

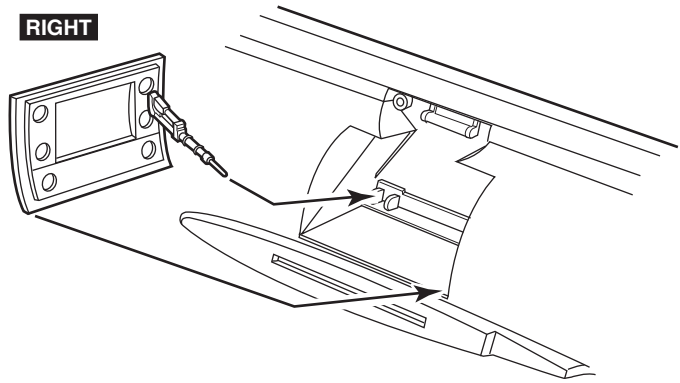

LEFT

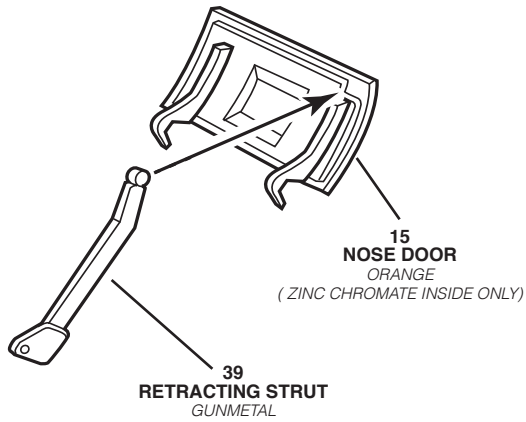
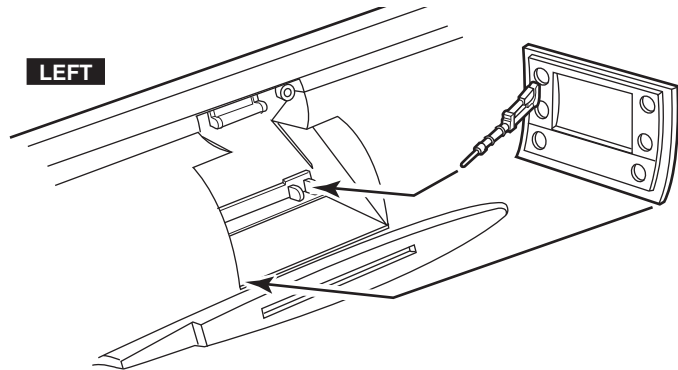

15
NOSE DOOR
ORANGE
(ZINC CHROMATE INSIDE ONLY)

39
RETRACTING STRUT
GUNMETAL

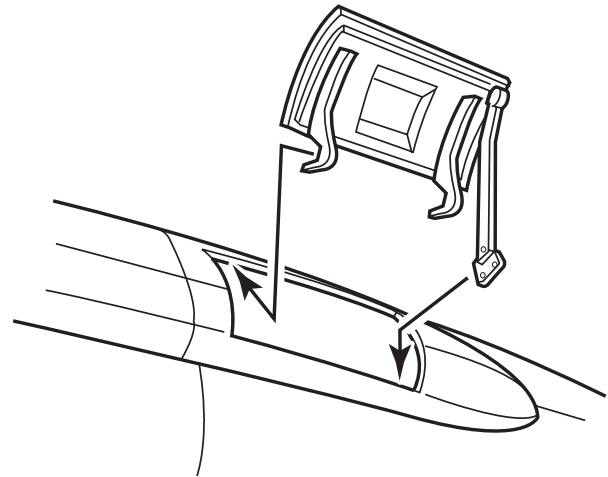

FRONT VIEW

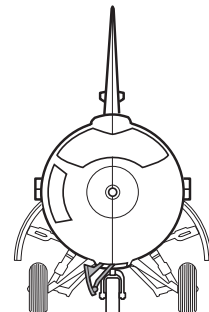
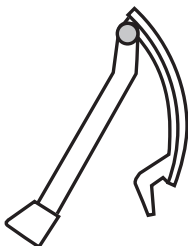

DOOR ANGLE

9

WING ASSEMBLY

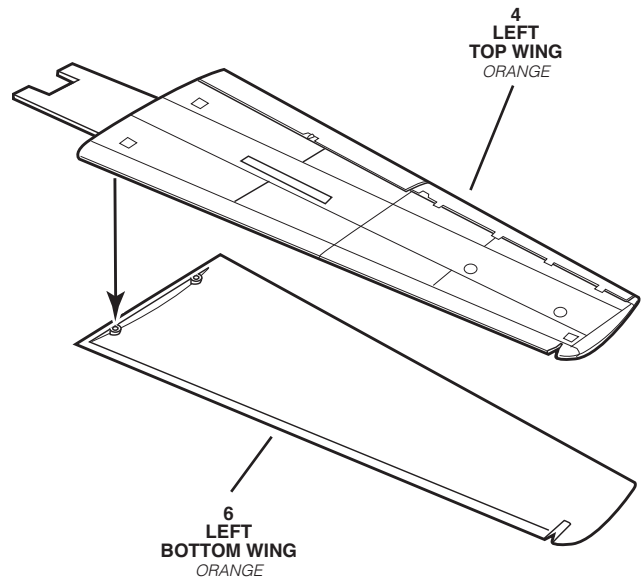
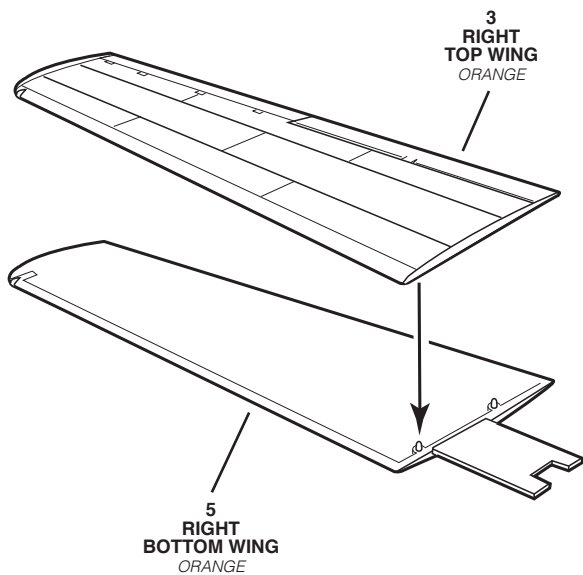

10

STABILIZER / WING ASSEMBLY

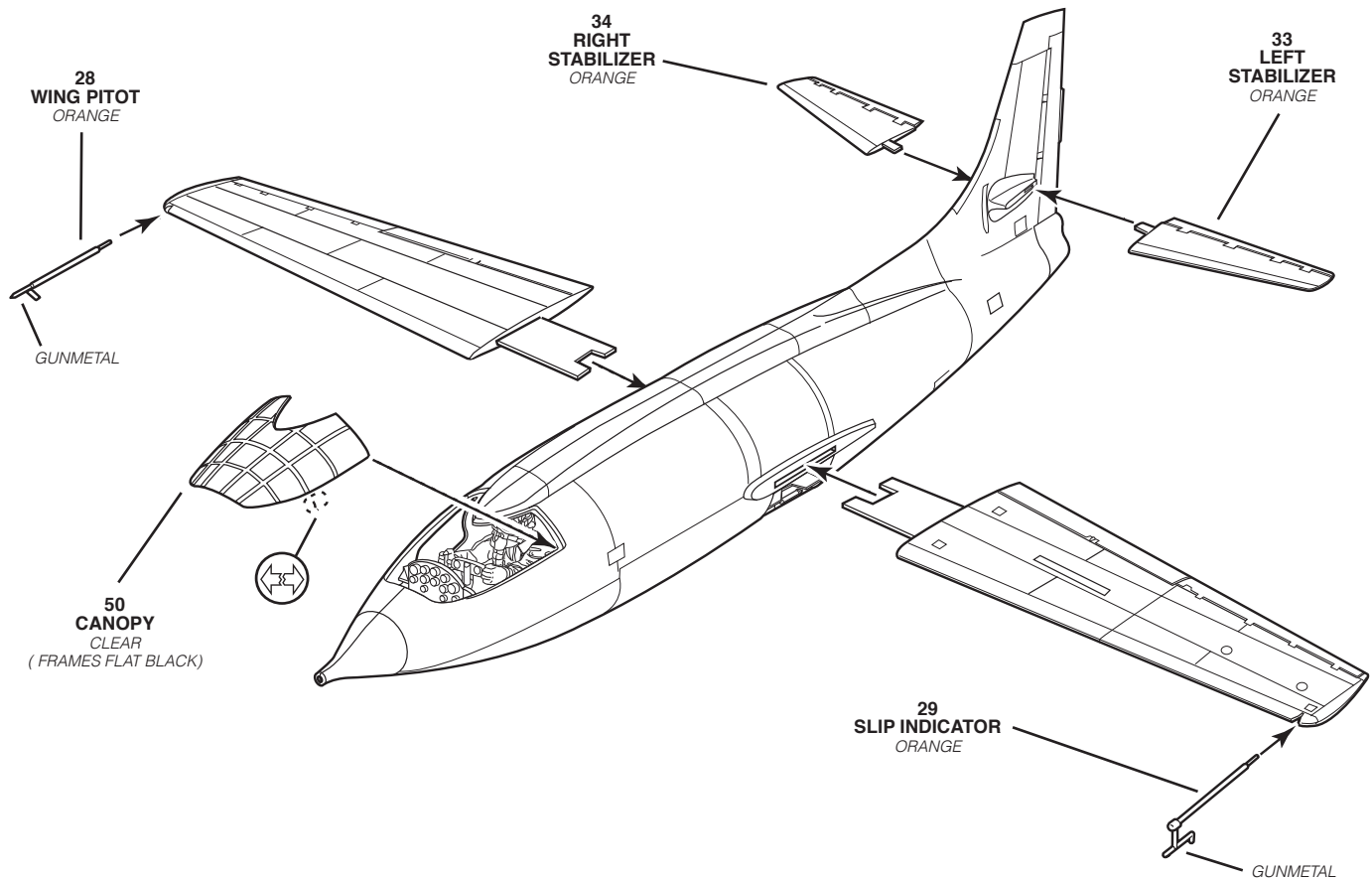

11

PITOT / DOOR ASSEMBLY

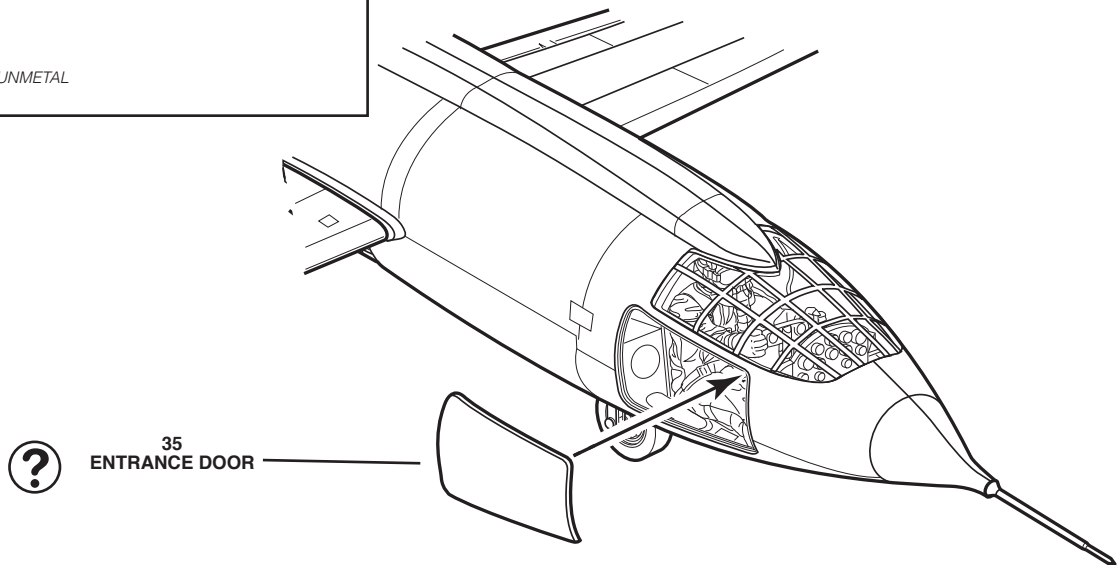
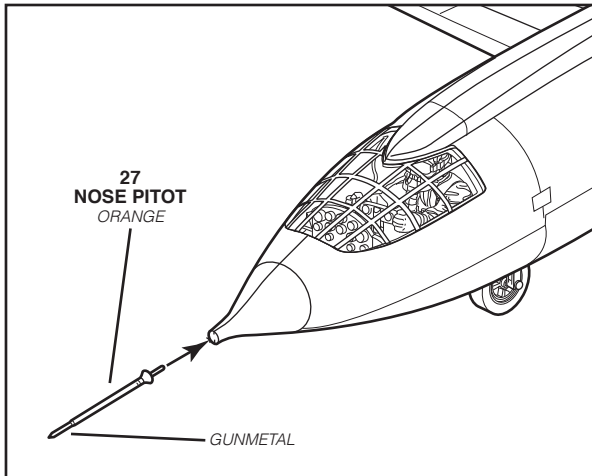

12

SUPPORT ASSEMBLY

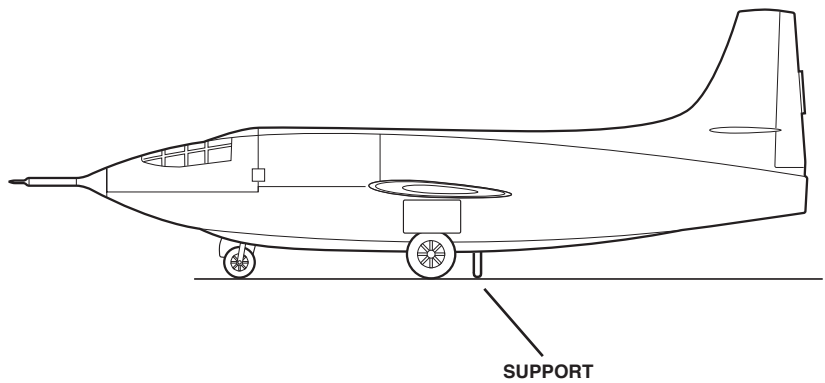
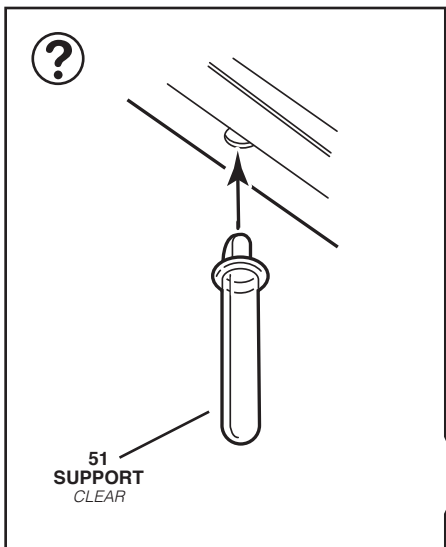

X-1 SUPERSONIC RESEARCH AIRCRAFT FIRST AIRPLANE DESIGNED FOR SUPERSONIC FLIGHT

Scheme on Yeager's October 14, 1947 flight.

The company logo was on the plane when delivered.

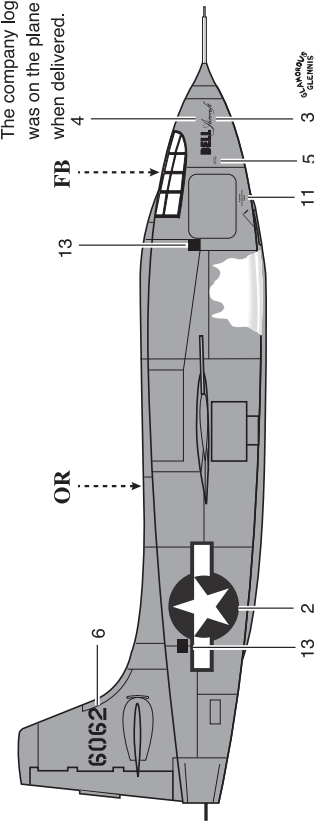

The name was added before the supersonic flight.

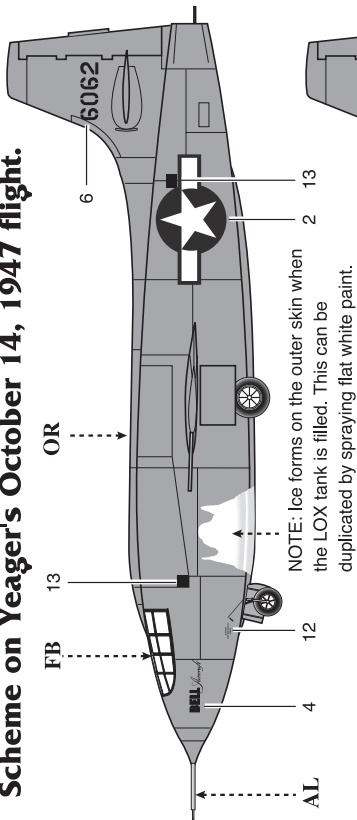
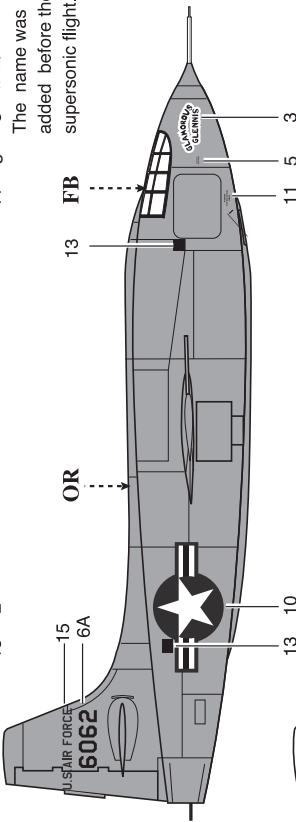

NOTE: Ice forms on the outer skin when the LOX tank is filled. This can be duplicated by spraying flat white paint.

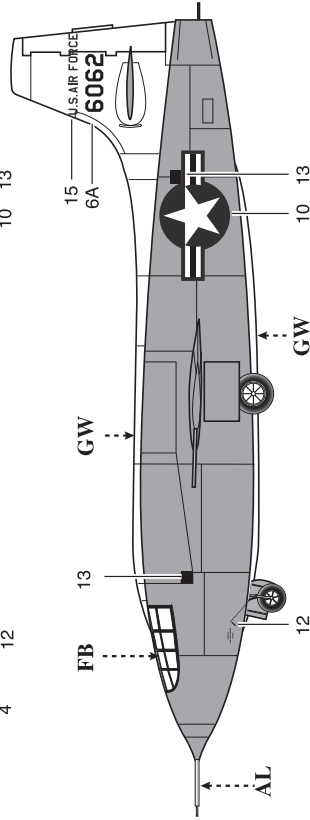
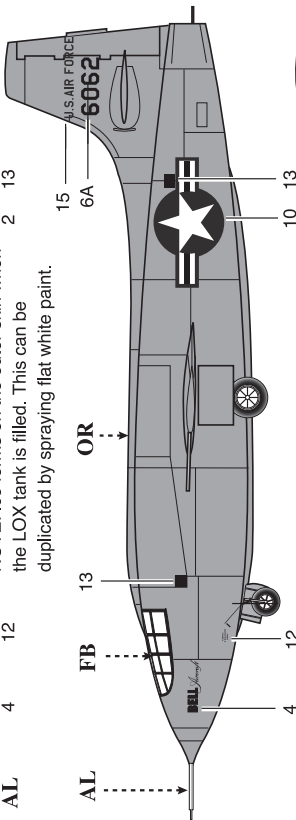

LEFT SIDE OF NATIONAL ADVISORY COMMITTEE FOR AERONAUTICS SCHEME 1. OPPOSITE SIDE IS SAME.

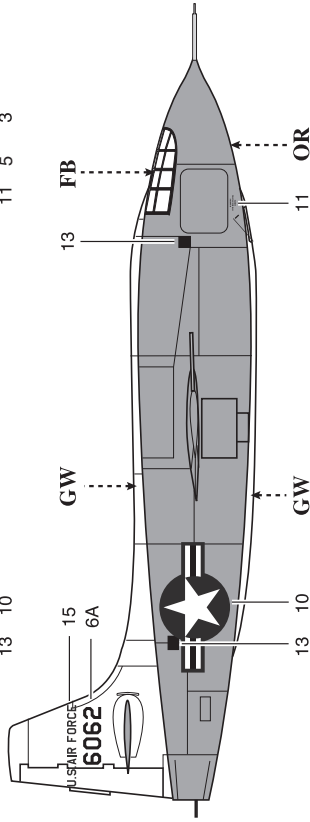
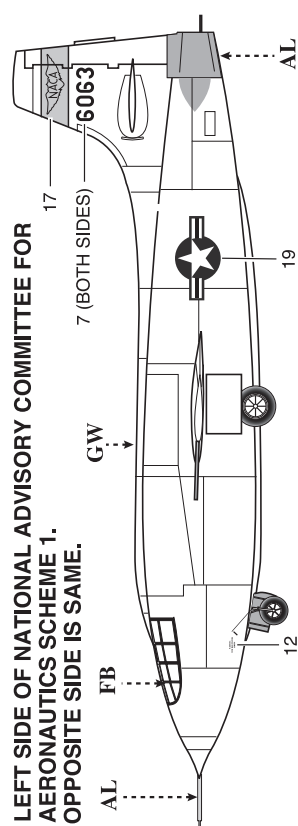

RIGHT SIDE OF NACA SCHEME 2 OPPOSITE SIDE IS SAME.

